

Determination of Fracture Behaviour of Structural Steels using Subsize Specimens

Ladislav Kander

MATERIAL & METALLURGICAL RESEARCH, Ltd.

Ostrava, Czech Republic

1st International Conference

Determination of Mechanical Properties of Materials by Small Punch
and other Miniature Testing Techniques

Ostrava, 31st August – 2nd September 2010

Content

- 1. Introduction – Master curve concept**
- 2. Specimens – standard, subsize**
- 3. Description of experiments**
- 4. Results**
- 5. Conclusions**

Introduction

- **Structural steels – bcc - transition behaviour**
- **Evaluation of fracture behaviour in transition region can be provided according to ASTM E 1921 standards.**
- **Recent standard E 1921 is based on „Master curve“ concept developed by Kim Wallin.**

Master curve concept

Master curve: temperature dependence of median of fracture toughness in the transition range

$$K_{JC}(\text{med}) = 30 + 70 \exp[0,019 (T-T_0)]$$

Master curve concept (ASTM E 1921) is based on the reference temperature T_0 . This is temperature at which median of fracture toughness for 1T specimen is equal $K_{JC(\text{med})} = 100 \text{ MPa m}^{1/2}$.

You can use specimens with other thickness B_1 and after test recalculated results on 1T thickness.

Specimens

➤ For fracture toughness tests

CT, SEB etc. with dimensions normally about
 $B = 25\text{mm}$, $W = 50\text{mm}$.

Precracked Charpy specimens also can be used
 $B = 10\text{mm}$, $W = 10\text{mm}$,

Large volume of testing material !

New approaches: SUBSIZE SPECIMEN

Miniaturized test techniques

- **Miniaturized Charpy specimen 3 x 4 x 27 mm (DIN 50 115)**
- **Miniaturized Charpy specimens 3 x 5 x 32 mm developed in our company several years ago**
- **Miniaturized 5 x 5 x 27 mm – can be used both for impact test as well as for fracture toughness test „1: 2 scaled Charpy“**

Specimens

Standard

Subsize

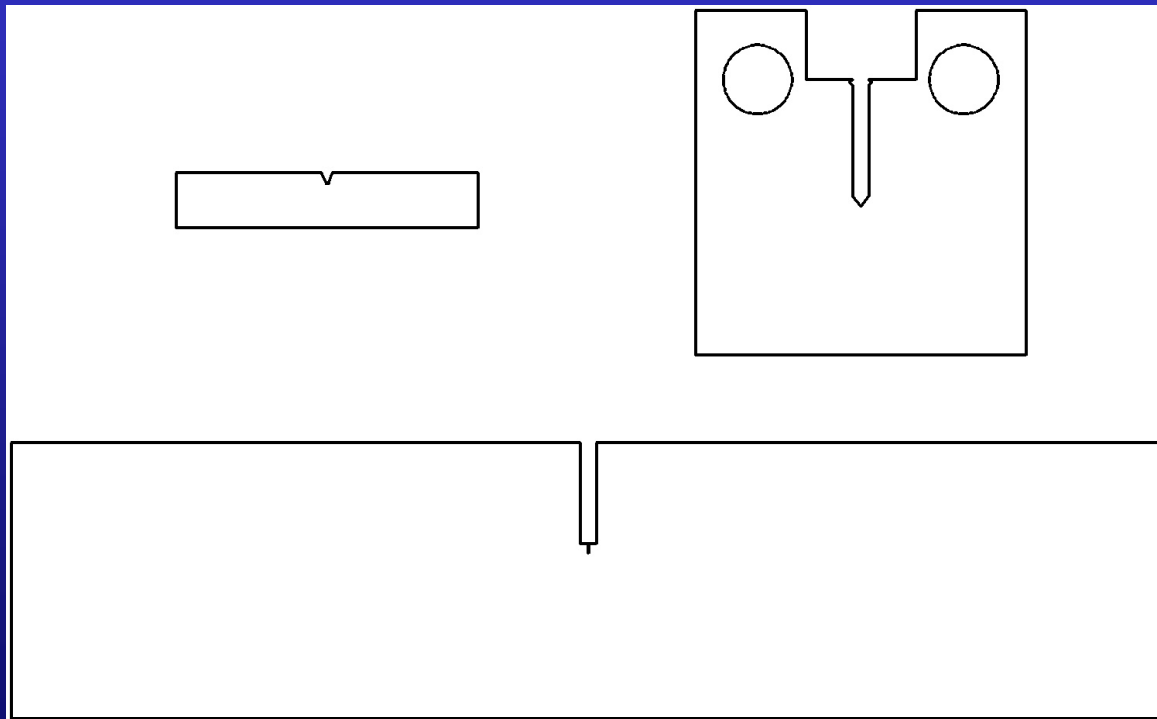

Motivation

- **Verification of 1:2 scaled Charpy specimens for several structural steels**
- **Comparison obtained results with results on standard fracture toughness specimens**

Steels:

Experimental program was carried out on 3 types of structural steels:

- **steel 13 116 – C – Mn microalloyed steel made in Vítkovice, weldable, developed for applications at arctic temperatures**
- **15NiCuMoNb5 (WB 36) – structural steel for steam power application for subcreep temperatures**
- **42CrMo4 – structural steel for shafts of wind power plants rotors**

Experiments

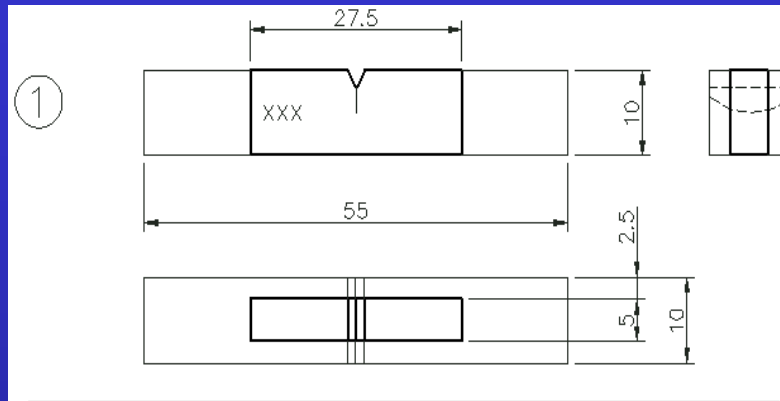

ROZMĚR L URČÍ ZADAVATEL PRO KAŽDOU VRUBOVKU SAMOSTATNĚ

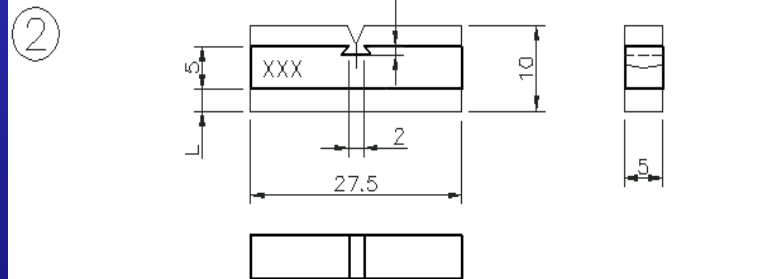

Standard Charpy specimens were manufactured.

Fatigue precrack procedure according to ASTM E 1921

fatigue crack $a_0/W \sim 0.5 K_{\max \text{ final}}$
below $18 \text{ MPa m}^{1/2}$.

1 : 2 scaled Charpy specimens were manufactured from precracked Charpy specimens

Experiments

Fracture toughness tests

three – point bending on servohydraulic test machine MTS 100 kN

- span $4 \times W$
- speed of testing 0.2 mm/min
- testing temperature ($-196 \div -130^{\circ}\text{C}$) (is necessary, due to loss of constraint, apply considerably lower testing temperature than the value of T_0)
- force versus CMOD dependence was recorded, J-integral and K_{JC} equivalent of fracture toughness were calculated

Experiments

- - all results were recalculated on 1T thickness and plotted into temperature dependencies of fracture toughness obtained on standards test specimens
- - for each type of specimen value of T_0 was calculated using multi-temperature approach.

Results:

13 116

$T_{0\text{ CT}} = -127^\circ\text{C}$

$T_{0\text{ Charpy}} = -122^\circ\text{C}$

$T_{0\text{ 1:2 Charpy}} = -124^\circ\text{C}$

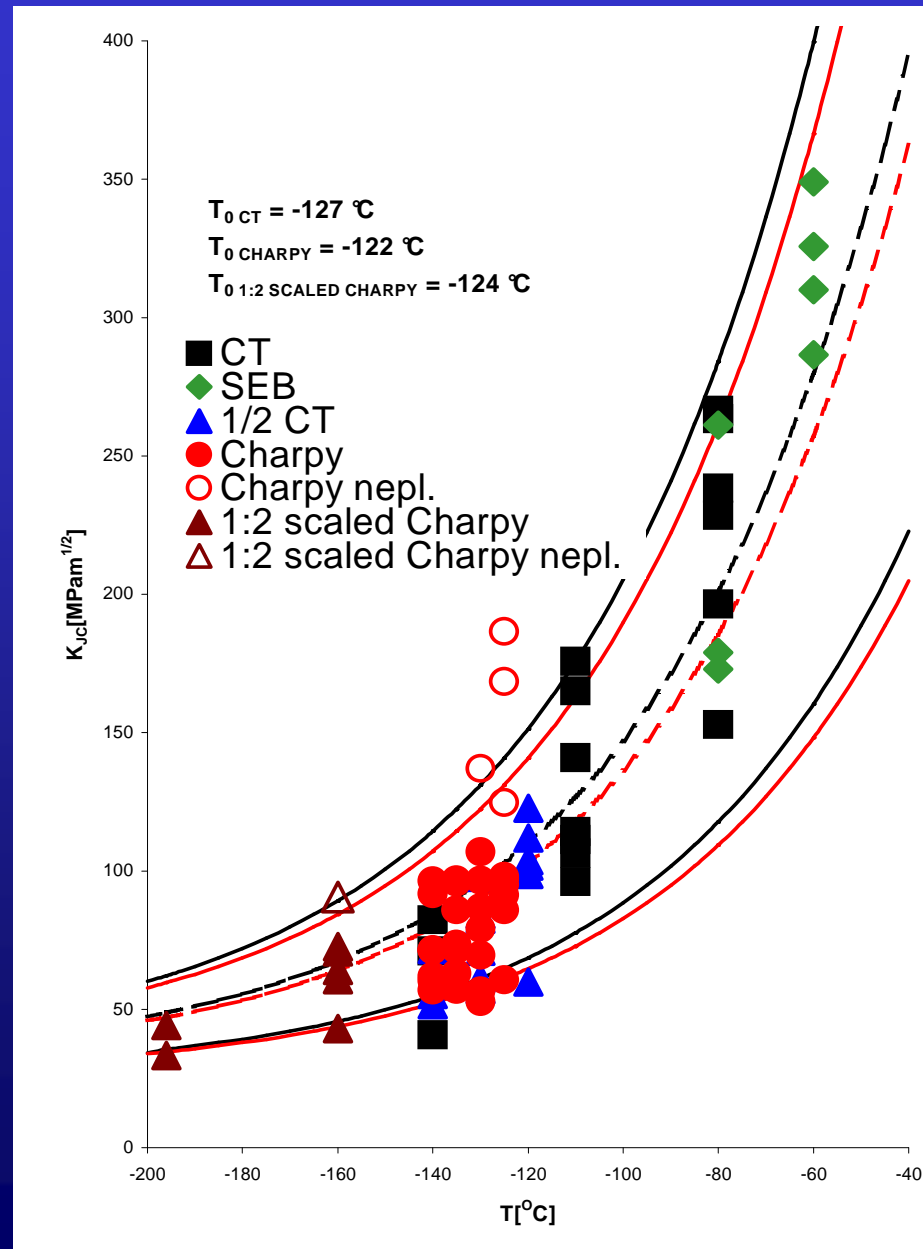

Results:

WB 36

$T_0 \text{ Charpy} = -105^\circ\text{C}$

$T_0 \text{ 1:2 Charpy} = -101^\circ\text{C}$

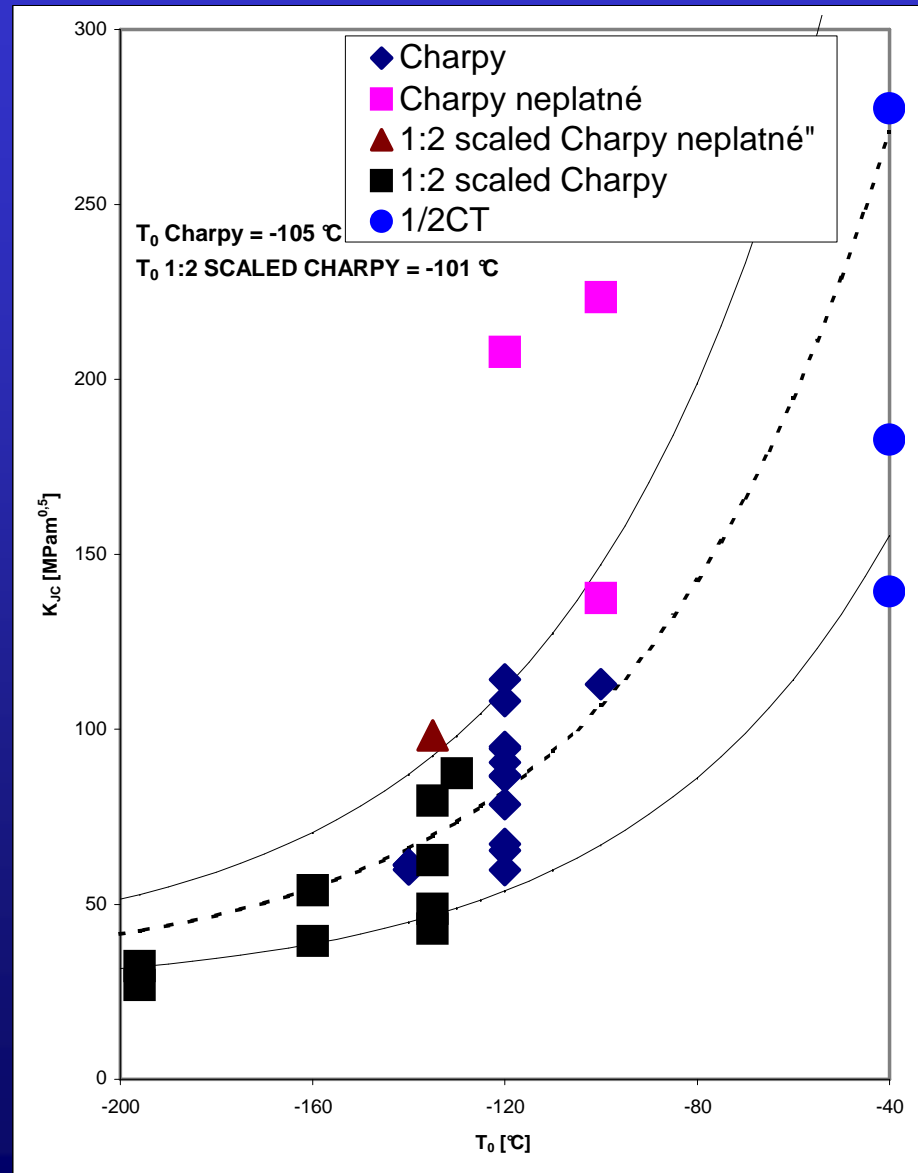

Results:

42CrMo4

$T_0 \text{ Charpy} = -103^\circ\text{C}$

$T_0 \text{ 1:2 Charpy} = -106^\circ\text{C}$

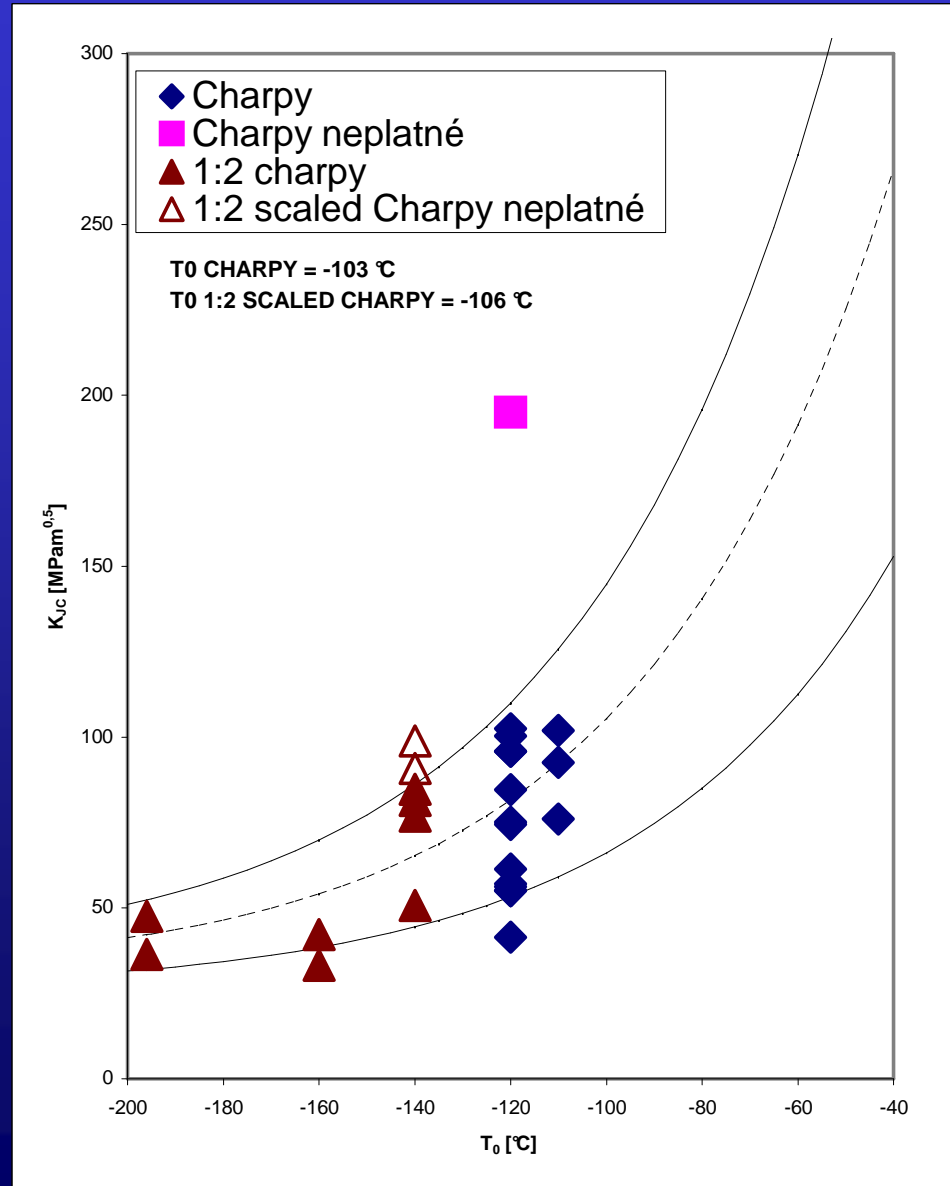

Optimization of testing temperature for 1:2 scaled Charpy specimens

Why ?

**If you test so small specimen at T_0 – not valid result
(over constraint limit or stable crack growth)**

**If you test below T_0 you can obtain strongly conservative
value of T_0**

From results

$$T_{\text{testing}} = T_0 - 35^{\circ}\text{C}$$

Summary :

- ❖ **New geometry of so called 1 : 2 scaled Charpy specimens was verified**
- ❖ **Verification was made on 3 types of structural steels covering wide range of technical applications**
- ❖ **Very good agreement was observed for all types of steel**
- ❖ **Based on the experimental results relation for calculation of correct test temperature was proposed**

Acknowledgement

This paper was prepared under financial support from the government funds through the MŠMT, project No. MSM 258 708 0701 and VZ MSM No. 6198910013.

Thank you for your attention